



“GlasArmor” by PolyOne / Glasforms

Ballistic Resistant FRP Panel Installation Guidelines

Proper installation of the “GlasArmor” panel is required for optimum ballistic resistance.

- Layout the project to utilize the largest “GlasArmor” panel sizes practical to minimize the number of seams.
- Fabricate the “GlasArmor” panels to the desired size by cutting with a circular saw equipped with a diamond abrasive blade. Be sure to wear appropriate safety equipment including safety glasses and dust masks when fabricating.
- Secure the “GlasArmor” panels to steel or wood framing by mechanically fastening with heavy-duty wallboard or lag screws as necessary..
- When constructing walls, rest the initial course of “GlasArmor” panels firmly on the floor to avoid any unsupported panel weight on the wall framing.
- Reinforce all panel seams with a minimum 4” batten of additional “GlasArmor” material. Position these batten strips to cover the seam and attach to both panels using appropriate wallboard screws.
- Use overlapping butt joints when installing panels into corners.
- “GlasArmor” panels expand to absorb ballistic impact. When covering a sensitive substructure such as glass, be sure to shim the panels 3/8” to prevent impact shock damage.
- “GlasArmor” panels can be finished by covering with drywall or paneling. Painting or wall covering of “GlasArmor” panels will require use of a suitable primer.
- Project specific installation assistance is available by contacting Glasforms at 1-800-297-3800 or sales@glasforms.com

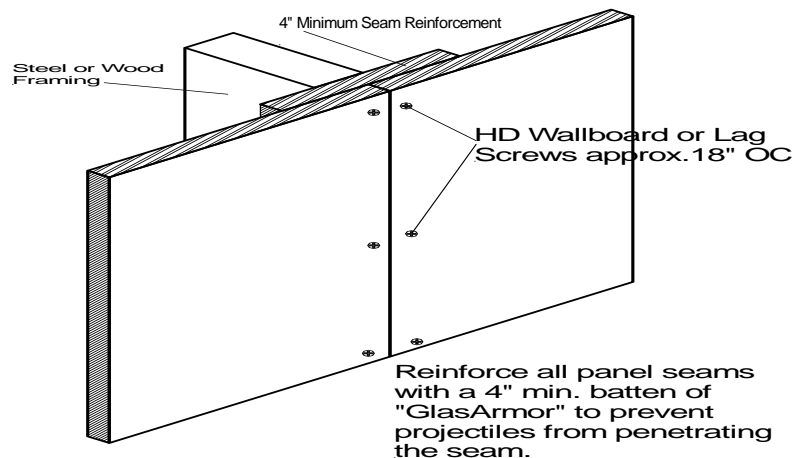

TYPICAL PANEL JOINT DETAIL

PolyOne / Glasforms Advanced Composites

Offices: 1226 Lincoln Ave San Jose, CA 95125

Manufacturing: 3850 Pinson Valley Pkwy Birmingham, AL 35217

Tel 888-297-3800 Fax 408-297-0601 Web www.glasforms.com